



HYMAX® FLANGE ADAPTOR AND FLANGE ADAPTOR LONG BODY (40mm - 1500mm)



INSTALLATION INSTRUCTIONS

DO NOT DISASSEMBLE THE FLANGE ADAPTOR. DO NOT LUBRICATE THE BOLTS.

GENERAL INSTRUCTIONS:

THE HYMAX FLANGE ADAPTOR IS A STAB-ON TYPE PRODUCT.

STEP 1

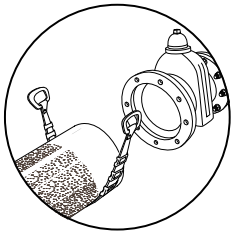

Prepare the pipe end. Clean and de-scale pipe end. Remove any debris or build up on the pipe end and clean the outer pipe surface with soapy water. Clean pipe end to a distance that is equal to the length of the center ring. Make sure there is no corrosion on the outer pipe end that could affect the gasket seal. Again, clean pipe end with water.

NOTE:

Sizes 40-600mm: Except steel, PVC, and PE pipes, all rough-surfaced pipes must be lubricated with a water-based gasket lubricant in order to achieve a proper seal.

Sizes 650-1500mm: All pipes must be lubricated with a water-based gasket lubricant in order to achieve a proper seal.

STEP 2

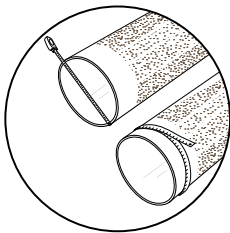

Measure the pipe's outer diameter and make sure the adaptor's size will fit properly.

NOTE: Each product's size range is shown on the product's label. Assure pipe is not out of round, free of scratches, dents, flats or other defects which may interfere with the coupling's proper seal. The HYMAX Flange Adaptor may not fit well or function properly on pipe which is not round or damaged.

STEP 3

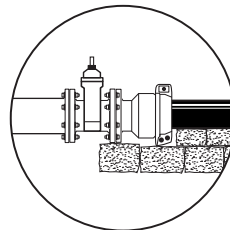

Unpack the HYMAX Flange Adaptor. Carefully remove it from the packaging. Inspect the HYMAX Flange Adaptor for shipping damage and verify that there are no missing parts.

NOTE: Hymax Flange Adaptor is a stab-on type coupling. Do not loosen the bolts on the end rings.

NOTE: Bolts are pre-lubricated with a dry coating. Do not field lubricate bolts/nuts. Greasing or field lubricating bolts/nuts voids warranty.

Make sure that the pipe is properly supported.

NOTE: The HYMAX Flange Adaptor is not designed to carry the weight of the pipe by itself.

STEP 4

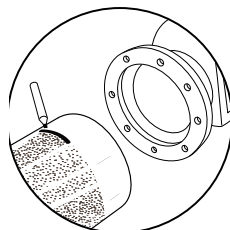

Mark each pipe end to a minimum required stab depth. This mark indicates the required stab depth for the HYMAX Flange Adaptor.

Sizes	Min. Stab Depth
40-300mm	55mm
350-1500mm	100mm

INSTALLATION INSTRUCTIONS

HYMAX® FLANGE ADAPTOR

AND FLANGE ADAPTOR LONG BODY 40mm - 1500mm

STEP 5

The Flange Adaptor gasket system has two layers, a removable inner gasket layer and a hydraulically assisted "outer gasket" layer. The "inner gasket" layer can be removed to accommodate larger OD pipes.

DO NOT remove the inner gasket unless the OD falls within the upper range of the coupling. The proper range sizes are shown on the product label. If the inner layer of the gasket must be removed, separate the two layers and break the parting line by inserting a screwdriver (1) between the two layers, peel the gasket layer (2) and pull it out of the coupling (3).

NOTE: Measure the OD of the pipe **TWICE** using an OD tape! Once the inner gasket is removed it can **NOT** be re-installed!

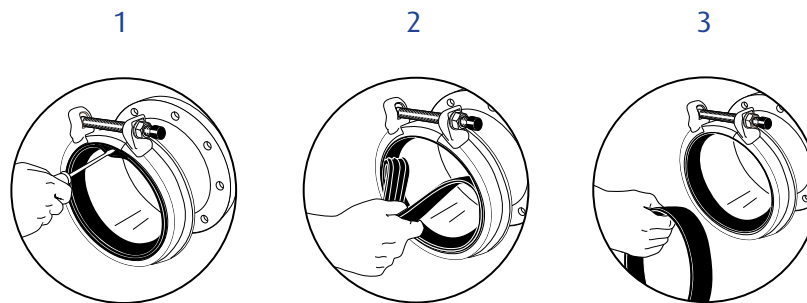

STEP 6

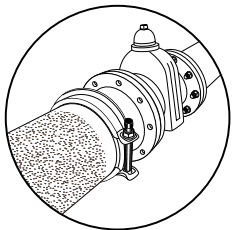

Position the HYMAX Flange Adaptor. Once the gasket is properly sized, position the HYMAX Flange Adaptor over the pipe end covering the marks on the pipe (step 4). For uncoated ductile iron, grey cast iron and asbestos cement pipe surfaces, appropriate gasket lubricant is required on both the inside surface of the gasket and the outer pipe surfaces.

All pipes above OD 600mm must be lubricated with a water-based gasket lubricant in order to achieve a proper seal.

STEP 7

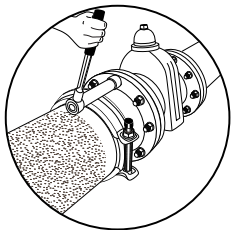

Assemble the flange joint using flange bolts. Make sure you use a flat gasket between the flanges (not provided).

STEP 8

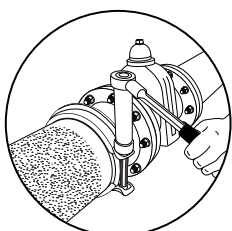

Tightening the end rings. Tighten the Flange Adaptor's bolts using a 19.05mm (3/4") socket wrench for 40-80mm Flange Adaptors, a 22.23mm (7/8") socket wrench for 100-300mm Flange Adaptors, a 23.81mm (15/16") socket wrench for 350-600mm Flange Adaptors, and a 38.10mm (1.5") socket wrench for 650-1500mm Flange Adaptors. Tighten the bolts evenly on each end ring in an alternating pattern to the torque mentioned on the label. Cross-tightening ensures that the gasket is evenly seated. When you finish, re-check the torque again.

DO NOT LUBRICATE BOLTS!

NOTE: Use of a torque wrench is required! The torque wrench will verify that the proper torque has been achieved. Refer to the product label for the proper torque settings.

INSTALLATION INSTRUCTIONS
HYMAX® FLANGE ADAPTOR
AND FLANGE ADAPTOR LONG BODY 40mm - 1500mm

STEP 9

Recharge the line and check for leaks. If any leakage across the seal end is evident, reduce the pressure in the line and increase the labeled torque of the end ring bolt/s by up to 50%.

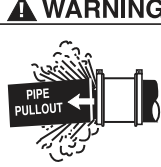
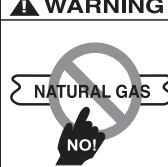
	<p>WARNING This product does not restrain axial pipe movement. Proper anchorage of the pipe is required if this product is used as a coupling. Failure to anchor the pipe ends could result in the escape of line content, and may cause property damage, serious injury or death.</p>		<p>Caution: This product is not intended for use on natural gas piping, or any other type of gas piping. To do so could result in escaping gas that could ignite and cause property damage, serious injury or death.</p>
-----------------------------------------------------------------------------------	-----------------------------------------------------------------------------------------------------------------------------------------------------------------------------------------------------------------------------------------------------------------------------------------------	------------------------------------------------------------------------------------	---------------------------------------------------------------------------------------------------------------------------------------------------------------------------------------------------------------------------------

Krausz Industries Ltd.

6 Hapatish St. Tel Aviv, Israel 6655906 | Tel: +972 (0)3 5154000 | Fax: +972 (0)3 5183293
Info@krausz.com | www.krausz.com

HYMAX® is a registered trademark of Krausz Industries Ltd.