



# HYMAX® GRIP FLANGE ADAPTOR

(80mm - 300mm)

## INSTALLATION INSTRUCTIONS

**DO NOT DISASSEMBLE THE COUPLING. DO NOT LUBRICATE THE BOLTS.**

### GENERAL INSTRUCTIONS:

THE HYMAX GRIP FLANGE ADAPTOR IS A STAB-ON TYPE RESTRAINT THAT IS APPROVED FOR USE WITH METAL AND PLASTIC PIPES.

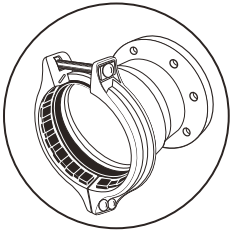

**WARNING:** DO NOT ATTEMPT TO USE THE HYMAX GRIP ON AC OR FRP PIPE!

PRECAUTIONS FOR HDPE PIPE: THE USE OF FULL CIRCLE STIFFENERS IS REQUIRED WHEN USING THE HYMAX GRIP FLANGE ADAPTOR ON HDPE PIPE.

FOR OTHER MATERIALS, PLEASE CONTACT YOUR KRAUSZ DEALER.

### STEP 1

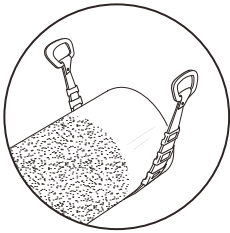

Prepare pipe end by de-scaling if required. Clean the pipe as required with water. Make sure that the pipe is clean from debris and defects that interfere with HYMAX GRIP's proper seal.

**NOTE:** Except steel, PVC, and PE pipes, all rough-surfaced pipes must be lubricated with a water-based gasket lubricant in order to achieve a proper seal.

### STEP 2

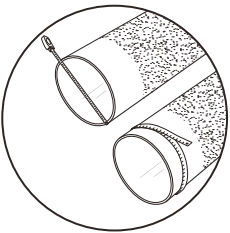

Measure the pipe's Outer Diameter and make sure the coupling's size fits properly.

**NOTE:** Each coupling's size range is shown on the product's label. Make sure that the pipe is not out of round! The pipe should be free of scratches, dents, flats or other defects which may interfere with the HYMAX GRIP Flange Adaptor's proper seal. The GRIP Flange Adaptor may not fit well or function properly on a pipe which is damaged or is out of round.

### STEP 3

Unpack the HYMAX GRIP Flange Adaptor carefully. Inspect the product and end ring for shipping damage and assure all parts are present.

Inspect the end ring. If it is not centered on the HYMAX GRIP Flange Adaptor - DO NOT USE! Contact your distributor for return and replacement.

**NOTE:** HYMAX GRIP Flange Adaptor is a stab-on type product. Do not loosen or remove the end ring bolts.

**NOTE:** Make sure that the product fits the flange standard of the flanged product you need to connect it to. The Flanged standard types appear in the submittal drawings.

**Size the gasket.**

The GRIP Flange Adaptor has two gaskets; a removable inner gasket and a hydraulically-assisted outer gasket. The inner gasket can be removed to accommodate larger OD pipes. DO NOT remove the inner gasket unless the OD falls within the upper range of the Flange Adaptor. The proper range sizes are shown on the product label. If the inner layer of the gasket must be removed, fold the inner layer and separate the two gaskets by inserting a screwdriver between the two layers, and pull the layer out of the product.

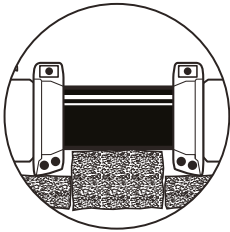
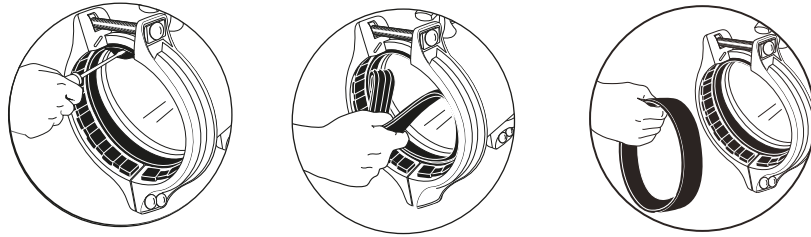

**NOTE:** Make sure that the pipe is properly supported. HYMAX GRIP Flange Adaptor cannot support the weight of the pipe by itself.

**NOTE:** Bolts are pre-lubricated with a MAG coating. This embedded zinc lubrication will prevent cold weld. Do not lubricate the bolts and nuts. Greasing or lubricating bolts or nuts voids the manufacturer's warranty

**STEP 4**

Mark pipe end to a minimum required stab depth. This mark indicates the required stab depth for the HYMAX GRIP Flange Adaptor.

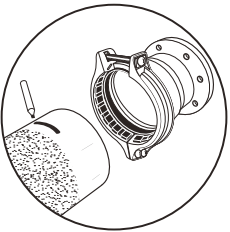

Sizes	Min. Stab Depth
40-175mm (Range 32mm)	95mm
175-300mm (Range 50mm)	125mm

The HYMAX GRIP Flange Adaptor fits a wide range of pipe sizes. Each product's range is shown on the product's label.

**STEP 5**

Place gasket (not provided by Krausz) between the GRIP flange and the flanged product. Connect the HYMAX GRIP Flange Adaptor to the existing flange and tighten bolts. Bring in the pipe. Stab the pipe onto the GRIP Flange Adaptor so it covers the mark on the pipe drawn in step #4 above.

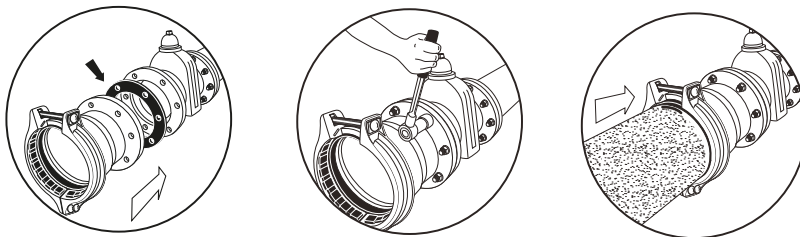

**STEP 6**

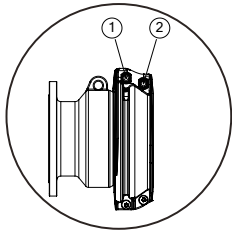

Tighten the end ring using a torque wrench, to the correct torque shown on the product's label.



**NOTE:** Use a torque wrench to tighten the bolts - this is required. A torque wrench will assure a proper torque has been applied to the coupling.

In products with 50mm range please tighten bolts as follows:

- A. Tighten bolt 1 to the specified torque to activate gasket seal
- B. Tighten bolt 2 to the specified torque to engage restraining mechanism
- C. Tighten bolts 1+2 by alternating between them until they have reached the specified torque

**STEP 7**

Recharge the line and check for leaks. If any leakage is evident, reduce the pressure in the line and increase bolt's torque by up to 50%. Verify again no leaks are evident along the seal.

 <b>WARNING</b>	<p><b>Caution:</b> This product is not intended for use on natural gas piping, or any other type of gas piping. To do so could result in escaping gas that could ignite and cause property damage, serious injury or death.</p>
 <b>NO!</b>	



**6 Hapatish St. Tel Aviv, Israel 6655906**

**TEL: (+972) 3-515-4014**

**FAX: (+972) 3-682-1572**

**[info@krausz.com](mailto:info@krausz.com) | [www.krausz.com](http://www.krausz.com)**