



HYMAX GRIP® REDUCER*

(40mm - 300mm)

PRODUCT SPECIFICATIONS

FEATURES

- JOINS AND RESTRAINS A WIDE RANGE OF PIPING TYPES AND DIFFERENT DIAMETERS
- UNIQUE RADIAL GRIPPING SYSTEM PREVENTS PIPE MOTION
- UNIVERSAL GRIPPING TEETH FIT METAL AND PLASTIC PIPES
- READY TO USE, STAB-FIT DESIGN
- ALLOWS 4° DYNAMIC DEFLECTION PER END, REDUCING FUTURE DAMAGE
- DURABLE DUCTILE IRON BODY
- PATENTED PROGRESSIVE PRESSURE-ASSISTED GASKET WITH 2-STAGE SEALING

SPECIFICATIONS (**)

STANDARDS

ALL PRODUCTS MEET OR EXCEED STANDARDS NSF-61 AND NSF-372.
 PRODUCTS WERE APPROVED BY 3RD PARTY ILAC LAB ACCORDING TO EN 14525.

SIZE

AVAILABLE IN NOMINAL DIAMETER SIZES 40mm – 300mm.

RANGES

26mm - 28mm: NOMINAL DIAMETERS 40mm – 100mm.

32mm: NOMINAL DIAMETERS 125mm – 175mm.

50mm: NOMINAL DIAMETERS 175mm – 300mm.

MATERIALS

END RINGS

40mm – 80mm: CAST STEEL ASTM A216 WCB.

100mm – 300mm: DUCTILE IRON CASTING ASTM A536 GRADE 60-40-18.

CENTER RING

40mm – 300mm: DUCTILE IRON CASTING ASTM A536 GRADE 65-45-12.
 PRODUCT SIZES 40mm – 300mm WITH HANDLE.

GASKET

EPDM COMPOUNDED FOR WATER AND SEWERAGE, MEETS INTERNATIONAL STANDARDS FOR CONTACT WITH DRINKING WATER: NSF-61, KTW-UBA ELASTOMER GUIDELINE, W270, XP P 41-250, AS/NZS 4020, AND BS 6920. MEETS DIN EN 681-1 FOR WATER AND DRAINAGE APPLICATIONS.

GRIP CHAIN

| SIZE | 40mm – 80mm | 100mm – 175mm | 175mm – 300mm |
|----------|-------------|---------------|---------------|
| MATERIAL | AISI-440C | AISI-420 2B | AISI-420 |

BRIDGE

AISI 304/316 STAINLESS STEEL.

SPHERICAL SPACERS

AISI 304/316 STAINLESS STEEL.

COATING

100% FUSION BONDED EPOXY FOR ENHANCED CORROSION PROTECTION. AVERAGE THICKNESS 250 MICRON. MEETS NSF-61, BS 6920, W270, ONORM B 5014-1, XP P 41-250, AS/NZS 4020, AND UBA-COATINGS GUIDELINE.

NUTS AND BOLTS

AISI 304/316 STAINLESS STEEL. ROLLED THREAD AND ANTI-GALLING COATING.

* The product is protected by various patents registered in various countries.

** For details about Made to Order (MTO) products please contact your KRAUSZ distributor.



HYMAX GRIP® REDUCER

(40mm - 300mm)

PRODUCT SPECIFICATIONS

PRODUCT PERFORMANCE

WORKING TEMPERATURE

EPDM GASKET

CONTINUOUS OPERATION | -30°C UP TO +85°C
 SHORT TIME OPERATION | -30°C UP TO +100°C

EPOXY COATING

ABOVE GROUND APPLICATIONS | UP TO +50°C
 BELOW GROUND APPLICATIONS | UP TO +65°C

DYNAMIC DEFLECTION

UP TO 4° PER SIDE

MIN. PIPE INSERTION

| | | |
|---------------------|--------|-------|
| RANGE | ≤ 32mm | 50mm |
| MIN. PIPE INSERTION | 95mm | 125mm |

MAX. OFFSET FOR MISALIGNED PIPE

40mm - 300mm
 6mm

MAX. OUT OF ROUNDNESS

| | | | |
|------------------|--------|-----------|--------|
| RANGE | ≤ 32mm | | 50mm |
| NOMINAL DIAMETER | ≤80mm | 100-175mm | ≥175mm |
| OUT OF ROUNDNESS | 3mm | 4mm | 5mm |

WORKING PRESSURE

16 BAR

RATED PRESSURE

24 BAR

VACUUM TEST

0.8 BAR

PRODUCT TABLES

HYMAX GRIP REDUCER 40-200

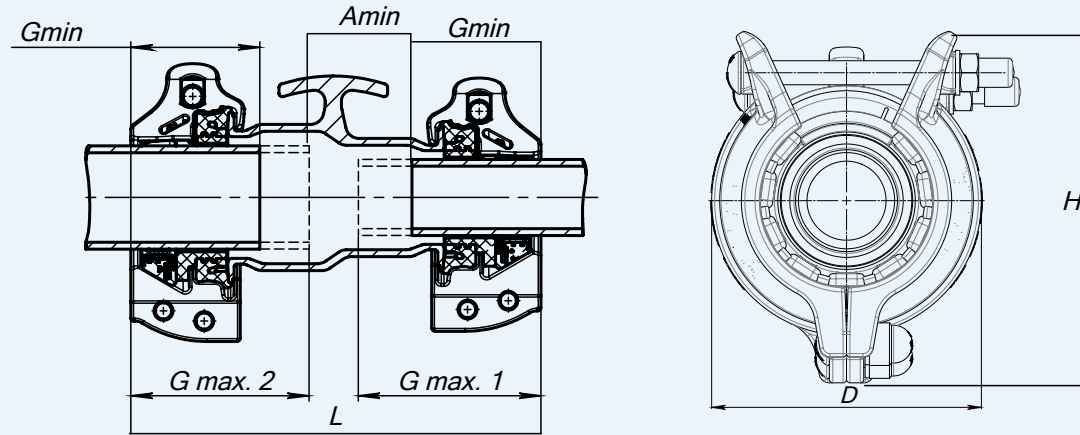

X=5 -> 304 STAINLESS STEEL

X=7 -> 316 STAINLESS STEEL

HYMAX GRIP REDUCER NOMINAL SIZES 40-100mm

| Krausz Part Number | DN (mm) | Range 1 | | | Range 2 | | | L (mm) | H (mm) | D (mm) | G-Max 1 Stab Depth (mm) | G-Max 2 Stab Depth (mm) | A min (mm) | Bolts Qty. -Size (mm) | Torque 1 (Nm) | Approx Weight (kg) |
|--------------------|--------------|--------------------|------------------------------------|-----------------------------------|--------------------|------------------------------------|-----------------------------------|--------|--------|--------|-------------------------|-------------------------|------------|-----------------------|---------------|--------------------|
| | | Overall Range (mm) | Before removal of inner layer (mm) | After removal of inner layer (mm) | Overall Range (mm) | Before removal of inner layer (mm) | After removal of inner layer (mm) | | | | | | | | | |
| 86382X0039005916 | (40/50) x 65 | 39-67 | 39-56 | 55-67 | 59-87 | 59-76 | 75-87 | 302 | 204.5 | 157 | 140 | 140 | 20 | 2 - M14 | 90 | 8.33 |
| 86382X0059008016 | 65 x 80 | 59-87 | 59-76 | 75-87 | 80-106 | 80-95 | 94-106 | 302 | 230 | 176 | 140 | 140 | 20 | 2 - M14 | 90 | 11.21 |
| 86382X0080010416 | 80 x 100 | 80-106 | 80-95 | 94-106 | 104-130 | 104-118 | 117-130 | 318 | 249 | 199 | 150 | 140 | 20 | 2- M16 | 100 | 12.15 |

HYMAX GRIP REDUCER NOMINAL SIZES 100-200mm

| Krausz Part Number | DN (mm) | Range 1 | | | Range 2 | | | L (mm) | H 1 (mm) | H 2 (mm) | D 1 (mm) | D 2 (mm) | G-Max 1 Stab Depth (mm) | G-Max 2 Stab Depth (mm) | A min (mm) | Bolts Qty. -Size (mm) | Torque 1 (Nm) | Torque 2 (Nm) | Approx Weight (kg) |
|--------------------|---------------|--------------------|------------------------------------|-----------------------------------|--------------------|------------------------------------|-----------------------------------|--------|----------|----------|----------|----------|-------------------------|-------------------------|------------|-----------------------|---------------|---------------|--------------------|
| | | Overall Range (mm) | Before removal of inner layer (mm) | After removal of inner layer (mm) | Overall Range (mm) | Before removal of inner layer (mm) | After removal of inner layer (mm) | | | | | | | | | | | | |
| 86382X0104013016 | 100 x 125 | 104-130 | 104-118 | 117-130 | 130-162 | 130-146 | 145-162 | 324 | 249 | 299 | 199 | 253 | 150 | 140 | 25 | 2-M16 | 110 | 110 | 17.1 |
| 86382X0104015816 | 100 x 150 | 104-130 | 104-118 | 117-130 | 158-190 | 158-174 | 173-190 | 334 | 249 | 330 | 199 | 280 | 145 | 145 | 25 | 2-M16 | 110 | 130 | 18 |
| 86382X0130015816 | 125 x 150 | 130-162 | 130-146 | 145-162 | 158-190 | 158-174 | 173-190 | 360 | 299 | 330 | 253 | 280 | 170 | 160 | 25 | 2-M16 | 110 | 130 | 21.3 |
| 86382X0130019816 | 125 x 175/200 | 130-162 | 130-146 | 145-162 | 198-230 | 198-214 | 213-230 | 362 | 299 | 375 | 253 | 324 | 150 | 150 | 35 | 2-M16 | 110 | 130 | 23.7 |
| 86382X0158019816 | 150 x 175/200 | 158-190 | 158-174 | 173-190 | 198-230 | 198-214 | 213-230 | 360 | 330 | 375 | 280 | 324 | 170 | 160 | 35 | 2-M16 | 130 | 130 | 24.7 |

PRODUCT TABLES

HYMAX GRIP REDUCER NOMINAL SIZES 150-300mm

HYMAX GRIP REDUCER 150&200

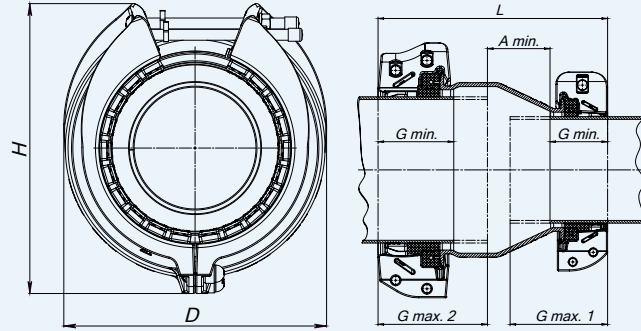

HYMAX GRIP REDUCER 175-300

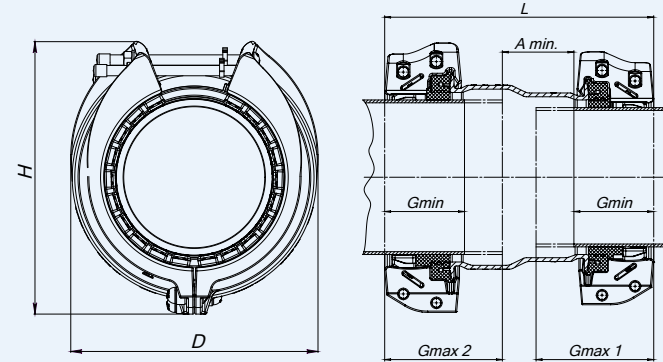

X=5 -> 304 STAINLESS STEEL

X=7 -> 316 STAINLESS STEEL

| Krausz Part Number | DN (mm) | Range 1 | | | Range 2 | | | L (mm) | H (mm) | D (mm) | G-max 1 stab depth (mm) | G-max 2 stab depth (mm) | A min (mm) | Bolts Qty. -Size (mm) | Torque 1 (Nm) | Torque 2 (Nm) | Approx Weight (kg) |
|--------------------|-----------|--------------------|------------------------------------|-----------------------------------|--------------------|------------------------------------|-----------------------------------|--------|--------|--------|-------------------------|-------------------------|------------|-----------------------|---------------|---------------|--------------------|
| | | Overall Range (mm) | Before removal of inner layer (mm) | After removal of inner layer (mm) | Overall Range (mm) | Before removal of inner layer (mm) | After removal of inner layer (mm) | | | | | | | | | | |
| 86382X0158021416 | 150 x 200 | 158-190 | 158-174 | 173-190 | 214-264 | 214-239 | 238-264 | 383 | 424 | 390 | 170 | 185 | 35 | 4 - M16 | 130 | 140 | 37.2 |
| 86382X0190021416 | 175 x 200 | 190-240 | 190-215 | 214-240 | 214-264 | 214-239 | 238-264 | 423 | 424 | 390 | 200 | 190 | 35 | 4 - M16 | 120 | 140 | 46.8 |
| 86382X0214026616 | 200 x 250 | 214-264 | 214-239 | 238-264 | 266-316 | 266-291 | 290-316 | 423 | 480 | 442 | 195 | 185 | 55 | 4 - M16 | 140 | 140 | 55.1 |
| 86382X0266031216 | 250 x 300 | 266-316 | 266-291 | 290-316 | 312-362 | 312-337 | 336-362 | 423 | 525 | 489 | 190 | 200 | 55 | 4 - M16 | 140 | 180 | 63.7 |

Copyright © 2017 Krausz Industries Ltd., All rights reserved

PS0026 REV C