

KRAUSZ®

a MUELLER brand

HYMAX GRIP® SWIVELJOINT (LALO) ANGLES 0° TO 90° (DN100-DN300) INSTALLATION INSTRUCTIONS

WARNING



Caution: This product is not intended for use on natural gas piping, or any other type of gas piping. To do so could result in escaping gas that could ignite and cause property damage, serious injury or death.

IMPORTANT

- **The HYMAX GRIP SWIVELJOINT** is a unique stab-on type restraint that connects and restrains two pipes at any angle from 0 to 90 degrees.
- **LUBRICATION OF PRODUCT AND PIPES:** except steel, PVC, and PE pipes, all rough-surfaced pipes must be lubricated with a water-based gasket lubricant in order to achieve a proper seal. Do not lubricate PVC, Steel or PE pipe surface.
- **DO NOT LUBRICATE BOLTS AND NUTS.** Bolts are pre-lubricated with a MAG (Molecular anti-galling) coating. Greasing bolts or nuts voids manufacturer's warranty.
- **USE A TORQUE WRENCH TO TIGHTEN THE BOLTS.** A torque wrench will assure a proper torque has been applied to the coupling. Do not use other tools to tighten the coupling's bolts!
- **PIPE STIFFENERS OR INSERTS ARE REQUIRED** when used on PE, PVC, and HDPE pipes. Only full circle stiffeners are approved for use with Krausz products. Such stiffeners can be purchased from Krausz. Please contact your local distributor for the stiffeners' catalogue.



JOIN



REPAIR



RESTRAIN



TAP

MUELLER

PREPARE PRODUCT AND PIPE FOR INSTALLATION:

STEP 1: PREPARE THE PIPE ENDS. CLEAN AND DE-SCALE THE PIPE AS NEEDED

Clean the pipes as required using water. Make sure that the pipe is clear from debris and defects that may interfere with the HYMAX GRIP SWIVELJOINT's proper seal.

NOTE: Except steel, PVC, and PE pipes, all rough-surfaced pipes must be lubricated with a water-based gasket lubricant in order to achieve a proper seal.

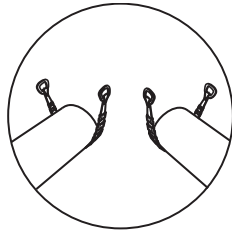

STEP 2: MEASURE

Measure both pipes' outer diameters and make sure the SWIVELJOINT's size will fit the pipes properly on both sides.

NOTE: The GRIP SWIVELJOINT's size range is shown on the product's label. Ensure that the pipes are not out of round and free of scratches, dents, flats or other defects which may interfere with the GRIP SWIVELJOINT's proper seal. The GRIP SWIVELJOINT may not fit well or function properly on pipe which is out of round or damaged.

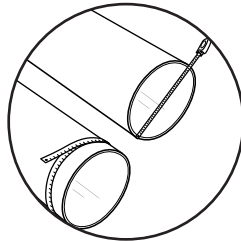

STEP 3: UNPACK THE GRIP SWIVELJOINT

Carefully remove the GRIP SWIVELJOINT from its packaging. Inspect the GRIP SWIVELJOINT, if the end rings are not centered on the SWIVELJOINT do not use! Contact your distributor for return and replacement!

NOTE: The GRIP SWIVELJOINT is a stab on coupling. Do not remove the end ring bolts.

NOTE: Bolts are pre-lubricated with a MAG (Molecular Anti Galling) dry coating. Do not lubricate the bolts and nuts. Greasing or lubricating bolts or nuts voids manufacturer's warranty.

STEP 4: MARK THE PIPES

Mark the pipe end of the existing pipe and the end of the replacement pipe to the minimum required stab depth as indicated on the product label.

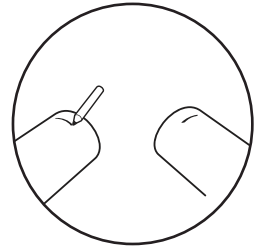

STEP 5: INSTALLATION

Slide the SWIVELJOINT on one pipe (Drawing 1) - do not tighten bolts.

Position it so that it covers the marks made in step 4.

For uncoated ductile iron and grey cast iron pipe surfaces, appropriate water-based gasket lubricant is required on both gaskets' inner surface and pipes' outer surface.

Do not lubricate PVC, steel or any PE pipe surfaces.

Slide the other coupling onto the other pipe. Insert the replacement pipe into the SWIVELJOINT (Drawing 2), but do not tighten the bolts.

Swivel the replacement pipe until it is in line with the other pipe.

Make sure that the pipes are properly supported (Drawing 3).

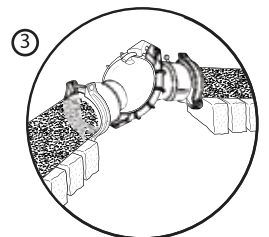
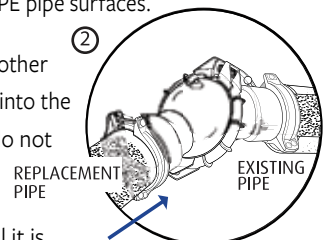
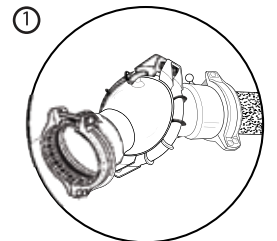

STEP 6: TIGHTEN

Tighten the central locking bolt on the middle part of the SWIVELJOINT (Drawing 1), and tighten the end rings (Drawing 2), to the correct torque shown on the product's label. By tightening bolts the GRIP SWIVELJOINT is steadily stabbed on the pipe.

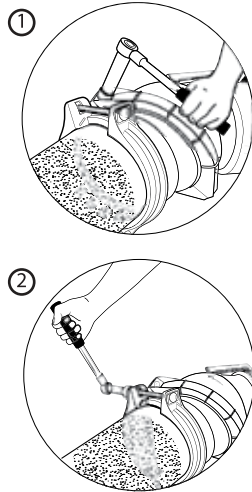

DO NOT LUBRICATE BOLTS!

NOTE: Use of a torque wrench is required! The torque wrench will verify that the proper torque has been achieved. Refer to the product label for the proper torque settings.

KRAUSZ	
HYMAX® GRIP SWIVELJOINT (Lalo)	
DN - 100	WORKING PRESSURE (bar): 16
<u>DIAMETER RANGE:</u>	MIN. SIDE TORQUE FORCE (Nm): 125
111-129 mm	MIN. CENTRAL TORQUE FORCE (Nm): 80
<u>AXIAL ANGLE:</u>	GASKET: EPDM
0° - 90°	COATING: EPOXY
1024 [0000] Part No: 892-625-04111-16	



STEP 7: RECHARGE

Recharge the line and check for leaks. If any leakage is evident, reduce the pressure in the line and increase bolt's torque up to 50%*. Verify again there are no leaks along the seal.

*In exceptional cases, where increasing bolt torque beyond standard declaration is required, contact your KRAUSZ local representative for more information.

For more information about us, or to view our full line of products, please visit www.mueller-international.com or call International Customer Service at:
KRAUSZ Headquarters: +972 (0)3 5154000 infokrausz@muellerwp.com

Mueller refers to one or more of Mueller Water Products, Inc. a Delaware corporation ("MWP"), and its subsidiaries. MWP and each of its subsidiaries are legally separate and independent entities when providing products and services. MWP does not provide products or services to third parties. MWP and each of its subsidiaries are liable only for their own acts and omissions and not those of each other. MWP brands include Mueller®, Echologics®, Hydro Gate®, Hydro-Guard®, HYMAX®, i2O®, Jones®, Krausz®, Mi.Net®, Milliken®, Pratt®, Pratt Industrial®, Sentryx™, Singer®, and U.S. Pipe Valve & Hydrant. Please see muellerwp.com/brands and krausz.com to learn more.

© 2024 Mueller International Holdings. All Rights Reserved. The trademarks, logos and service marks displayed in this document are the property of Mueller, its affiliates or other third parties. Products above marked with a section symbol (§) are subject to patents or patent applications. For details, visit www.mwppat.com. These products are intended for use in potable water applications. Please contact your Krausz Sales or Customer Service Representative concerning any other application(s).

110091 REV 11/2024

MUELLER